

WEST SUSSEX COUNTY COUNCIL
((CRAWLEY BOROUGH) (PARKING PLACES AND TRAFFIC REGULATION)
(CONSOLIDATION) ORDER 2010)
(DOBSON ROAD & VARIOUS ROADS AMENDMENT) ORDER 2016

CRAWLEY: LOCATION OF WAITING RESTRICTIONS

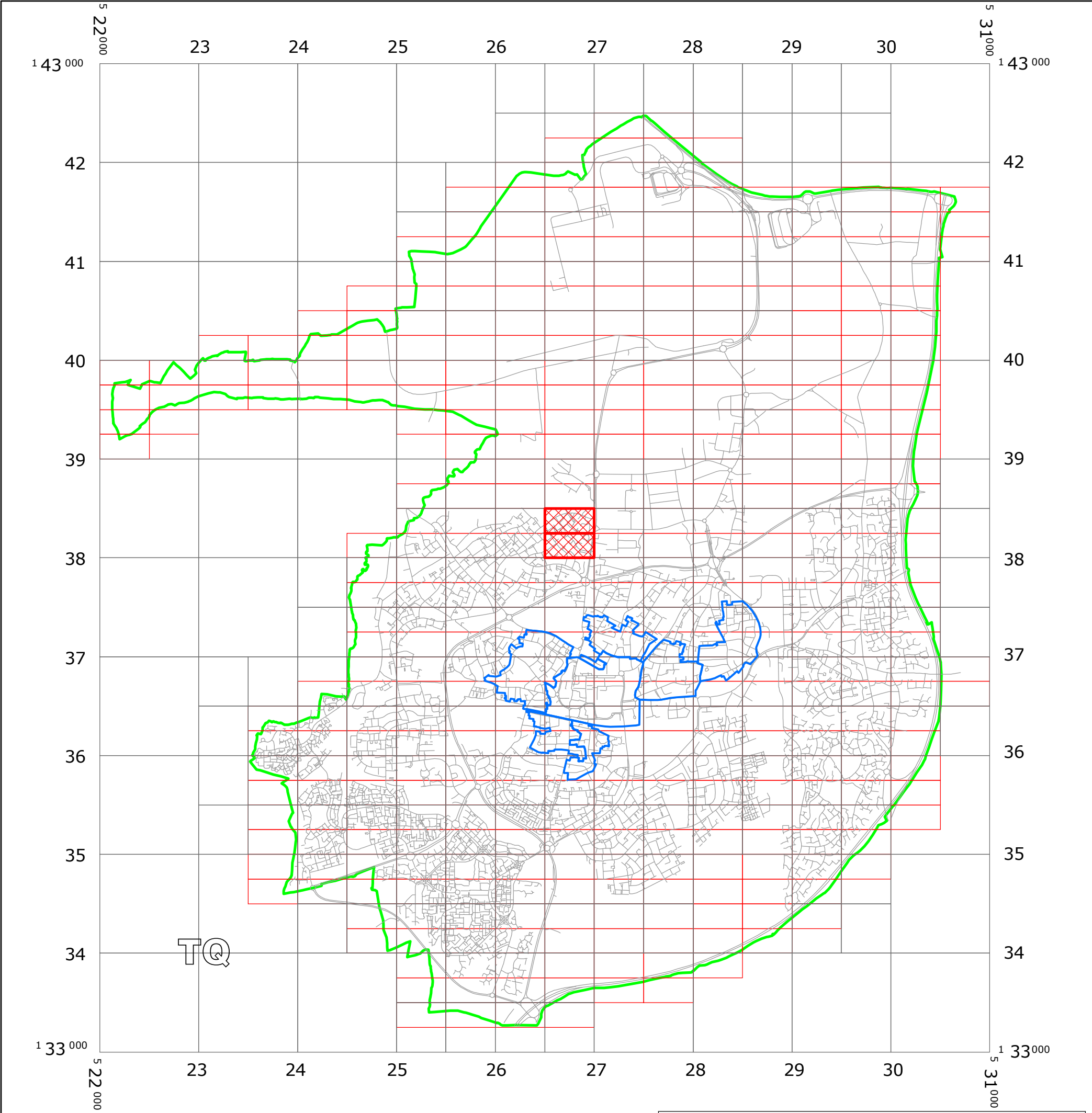

KEY:

OS TILE GRID

PARKING TILE GRID

LOCATION OF WAITING RESTRICTIONS

PARISH BOUNDARY



CONTROLLED PARKING ZONE BOUNDARY

ROAD NETWORK

Key for Waiting Restrictions

All areas over which the provision of the orders apply are defined by the shaded areas as shown on the following plans plus a contiguous area not indicated on the plans of verge and/or footway between the carriageway edge and the highway boundary. The plans in this schedule are based upon grid references of the Ordnance Survey National Grid defined by the OSGB 36 triangulation.

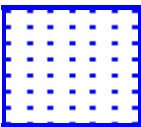
Prohibition of waiting at any time

101		check	No waiting at any time
112		dot5	No waiting 8.00am-6.00pm Mon-Fri
			Boundary of Controlled Parking Zone

WEST SUSSEX COUNTY COUNCIL
((CRAWLEY BOROUGH) (PARKING PLACES AND TRAFFIC REGULATION)
(CONSOLIDATION) ORDER 2010)
(DOBSON ROAD & VARIOUS ROADS AMENDMENT)
ORDER 2016

West Sussex County Council in exercise of their powers under Sections 1 (1) 2 (1) and (2), 4 (2), 45, 46, 49 and 53 and Part IV of Schedule 9 of the Road Traffic Regulation Act 1984 "the Act" as amended and of all other enabling powers and after consultation with the chief officer of police in accordance with Part III of Schedule 9 to the Act hereby make the following Order:-

1. This Order shall come into operation on the 10th day of July 2016 and may be cited as "West Sussex County Council ((Crawley Borough) (Parking Places and Traffic Regulation) (Consolidation) Order 2010) (Dobson Road & Various Roads Amendment) Order 2016."
2. The "West Sussex County Council (Crawley Borough) (Parking Places and Traffic Regulation) (Consolidation) Order 2010" is hereby amended by the deletion from it of the plans specified in the First Schedule to this Order and the substitution of the plans attached in the Second Schedule to this Order.

FIRST SCHEDULE
Plans to be deleted

TQ2638SEN (Sheet Issue No. 3)
TQ2638SES (Sheet Issue No. 1)

SECOND SCHEDULE
Plans to be substituted
(as attached)

TQ2638SEN (Sheet Issue No. 4)
TQ2638SES (Sheet Issue No. 2)

THE COMMON SEAL of WEST SUSSEX
COUNTY COUNCIL was hereto affixed

the SECOND day of August 2016
in the presence of:

Authorised Signatory

)
)
)
)
) (L.S)
)
)
)
)



I HEREBY CERTIFY THIS TO
BE A TRUE COPY OF THE
ORIGINAL DOCUMENT

04/08 DELEGATED AUTHORITY

.....
Authorised Officer
WEST SUSSEX COUNTY COUNCIL

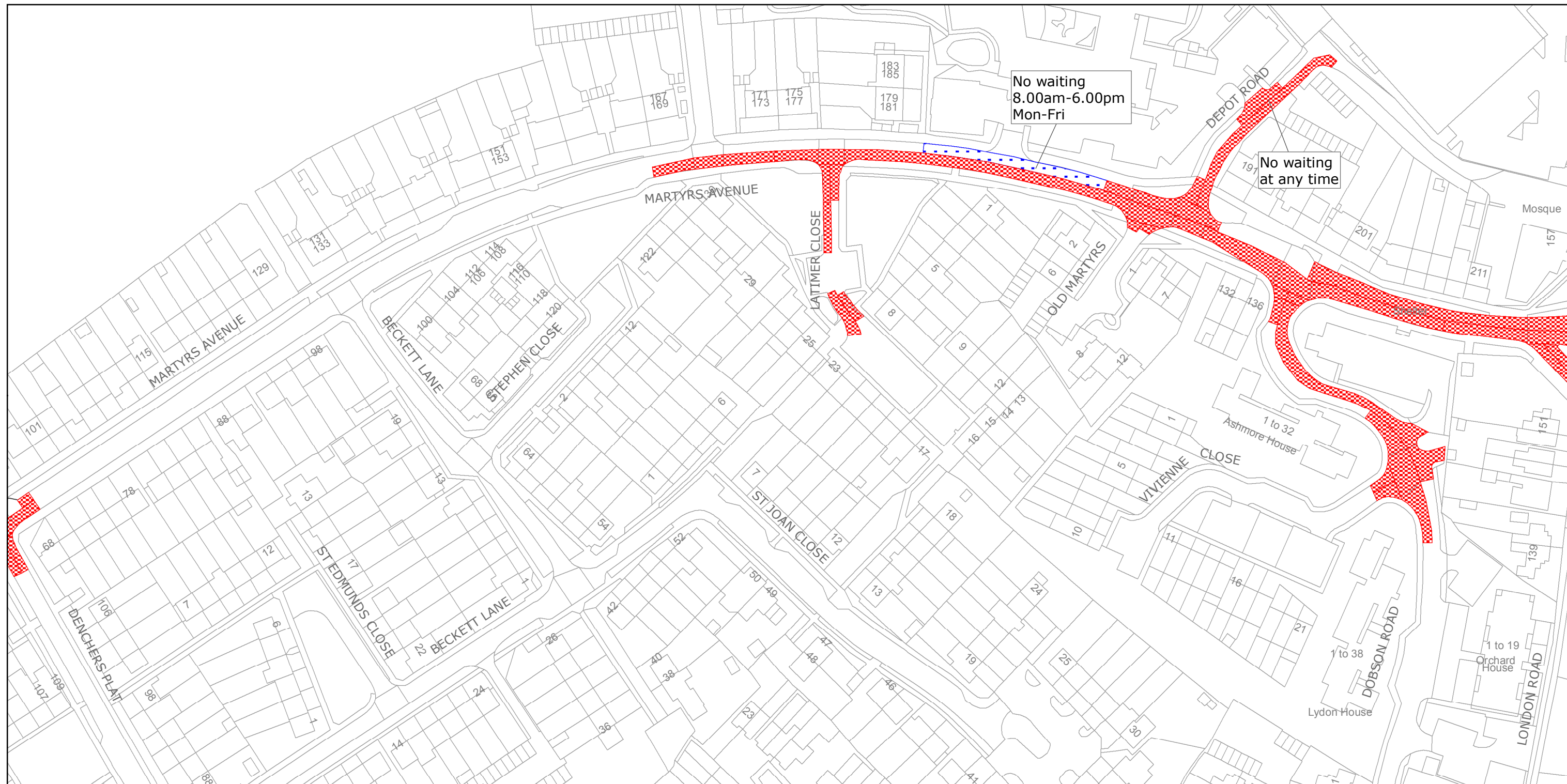

West Sussex County Council
Highways & Transport
The Grange
Tower Street
Chichester
West Sussex
PO19 1RH

CRAWLEY BOROUGH: LANGLEY GREEN WARD

WAITING RESTRICTIONS

Reproduced from or based upon 2013 Ordnance Survey material with permission of the Controller of HMSO (c) Crown Copyright reserved.
Unauthorised reproduction infringes Crown copyright and may lead to prosecution or civil proceedings West Sussex County Council Licence No. 100023447

TILE REF NO: TQ2638SEN

SHEET ISSUE NO 4
SHEET ACTIVE FROM - 08/08/2016



SCALE:
1:1250
at A3 size



West Sussex County Council
Highways & Transport
The Grange
Tower Street
Chichester
West Sussex
PO19 1RH

CRAWLEY BOROUGH: LANGLEY GREEN AND
NORTHGATE WARDS

WAITING RESTRICTIONS

Reproduced from or based upon 2013 Ordnance Survey material with permission of the Controller of HMSO (c) Crown Copyright reserved.
Unauthorised reproduction infringes Crown copyright and may lead to prosecution or civil proceedings West Sussex County Council Licence No. 100023447

TILE REF NO:
TQ2638SES

SHEET ISSUE NO 2
SHEET ACTIVE FROM - 08/08/2016

N

SCALE:
1:1250
at A3 size